



The Mohave County Airport Authority invites applications for
Airport Director

Laughlin/Bullhead International Airport (IFP)
Bullhead City, AZ

EXECUTIVE SEARCH SERVICES PROVIDED BY ADK CONSULTING & EXECUTIVE SEARCH



The Airport

Laughlin/Bullhead International Airport (IFP) is a public use airport located one mile north of the central business district of Bullhead City in Mohave County, Arizona. It is owned by Mohave County. The airport is across the Colorado River and one block away from Laughlin, Nevada. Many of the rooms at Laughlin's casino-hotels offer a view of the airport. It was named 2011 Airport of the Year by the Arizona Department of Transportation from among the 65 airports located in the state and is the 6th busiest airport in the state.

The airport is operated by the Mohave County Airport Authority, Inc. (MCAA), a nonprofit corporation formed under Arizona Revised Statutes for the purpose of operating a public airport. As such, MCAA does not receive tax funds from municipal, county or state sources to operate the Laughlin/Bullhead International Airport. All costs of operation, maintenance and capital improvement matching funds must be derived from revenue generated from airport commercial sources. Currently, IFP has charter service only - no scheduled service. IFP is a Part 139 Commercial Service airport.

MCAA is actively pursuing scheduled air service and uses the top air service consultant in the industry.

MCAA has 16 employees, all non-union. The operational budget FYE 2023 is approximately \$2.1 million and there were 130,000 enplanements and 11,000 operations in 2019. Passenger numbers are steadily increasing post-pandemic.

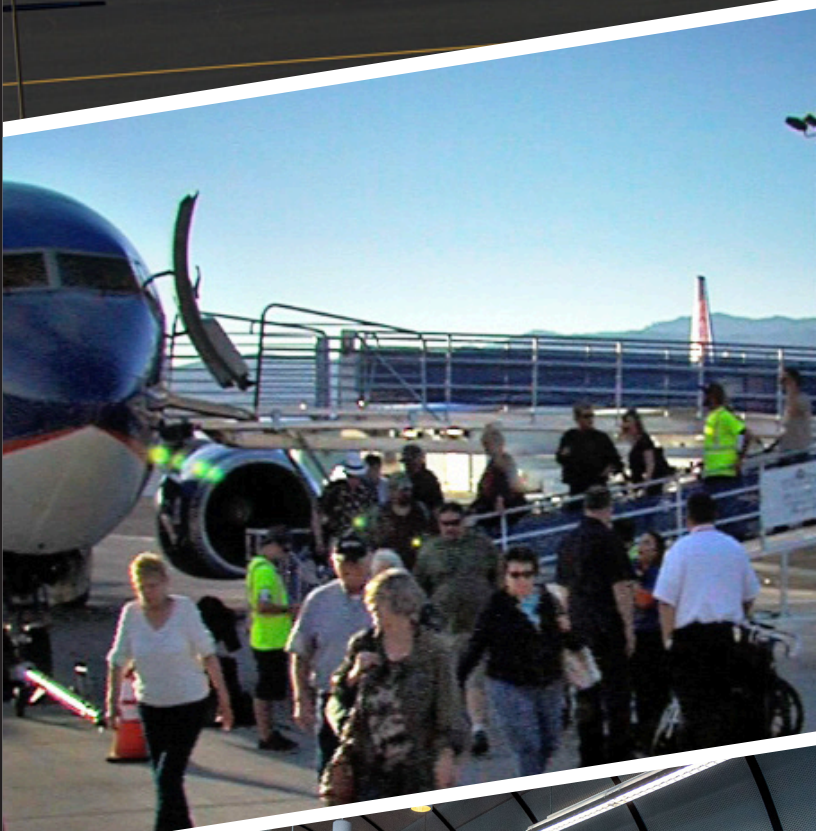

The Airport (*continued*)

Significant operators at the airport include:

- Signature Flight Support
- TriState CareFlight - Air ambulance service local headquarters
- Sun Country Airlines

Tenants of the Airport commercial center (operated by MCAA) include Home Depot, Sam's Club, McDonalds, Chilis, Carl's Jr, Taco Bell, IHOP, and Panda Express.

Current and upcoming capital improvement projects:

- 2022 - In final stages of passenger terminal public restrooms renovations
- 2022 - Commercial terminal apron security lighting upgrade to LED coming soon
- 2022 - Runway PAPI upgrade to LED is under final design
- 2022 - Currently finalizing the purchase of ARFF foam testing equipment
- 2022 - Taxiway Alpha rehabilitation design is underway
- 2023 - Remodel passenger holding room and restrooms
- 2023 - Runway sealcoat project
- 2023 - TWY A rehabilitation construction
- 2023 - Construction of new t-hangars
- 2023 - GA apron sealcoat
- 2023 - Replace AWOS

Laughlin/Bullhead International Airport covers an area of approximately 850 acres. It has one runway designated 16/34 with an asphalt surface measuring 8,500 by 150 feet. Along with commercial aircraft, the 8,500-foot runway accommodates a diverse mix of activity including U.S. Military C-130's and Osprey tiltrotor aircraft; private and corporate jets; along with the occasional Boeing 767 and 747.

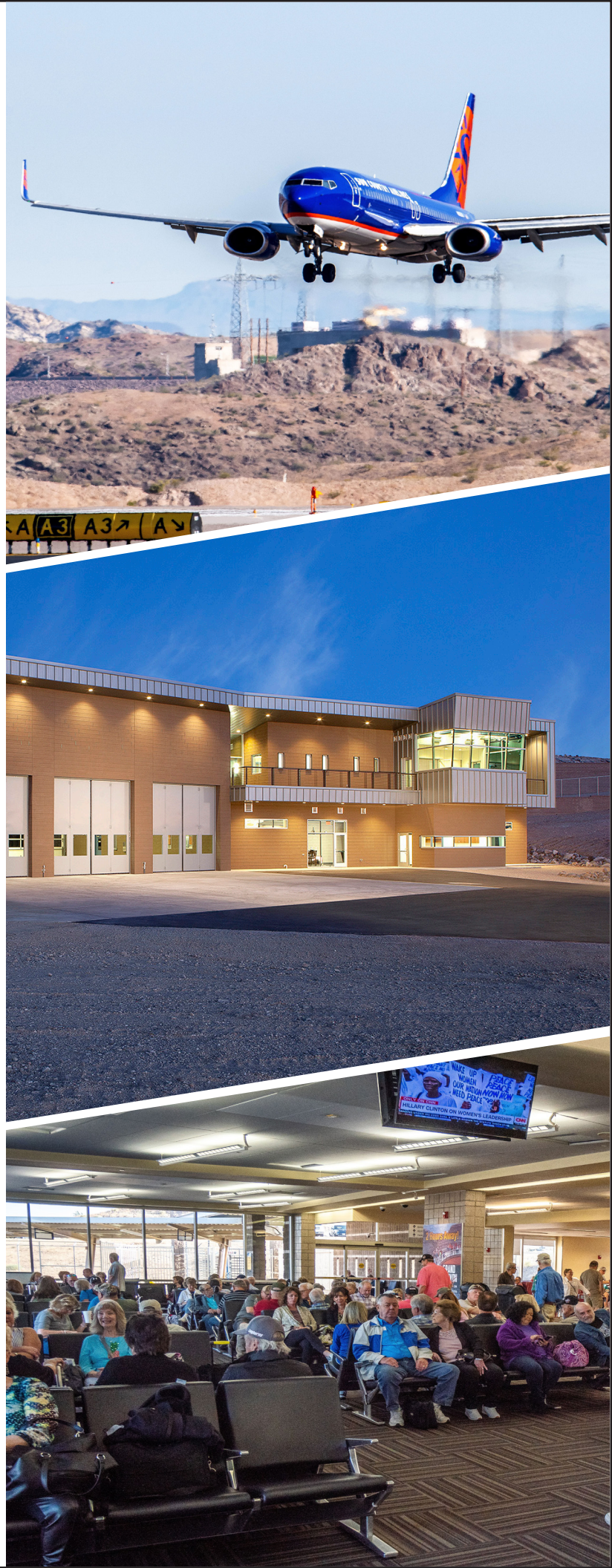



The Community

Bullhead City is located along the Colorado River, roughly 90 miles south of Las Vegas and across the river from the casino gaming town of Laughlin, Nevada. Bullhead City is a desert paradise with nearly 340 days of sunshine a year. With a pristine desert climate and clean air, this is an ideal playground for water-based activities and desert trail lovers. Full of year-round special events, thousands of people drive and fly into our community annually to enjoy the many amenities that the Tri State area has to offer. With a population of nearly 40,000 full-time residents, there is the friendliness of a small town; yet it is only 90 miles away from the bustling metropolis of Las Vegas.

Bullhead City has been referred to as Arizona's West Coast because the city is located on the east bank of the Colorado River near the juncture of Arizona, California, and Nevada. This makes for an ideal playground of water-based recreation including boating, canoeing, fishing, jet skiing, kayaking, paddle boarding, swimming, tubing, water skiing and wake boarding. Water enthusiasts have the choice of the fast-flowing Colorado River or the warm, smooth waters of Lake Mohave.

Bullhead City serves as the economic hub and retail shopping center for Western Mohave County and Southeastern Clark County, Nevada. It's easily accessible by major highways and a short drive from Los Angeles, Phoenix, and Las Vegas.

Located directly across the Colorado River is Bullhead City's sister city, the popular gaming community of Laughlin, Nevada. Tourism is a primary economic activity with approximately two million visitors per year. Visitors can explore the many well-hidden outdoor adventures around Laughlin and the Colorado River Region. After spending the day hiking, swimming, or golfing, the many resort casinos provide an extraordinary nightlife of fine dining, dancing, and of course, the many games of chance.



The Position

This is a highly responsible and visible position directing all activities of the Laughlin/Bullhead International Airport. Work is accomplished through airport staff engagement with aircraft operations; buildings and field maintenance; community relations; coordinating airline requirements; reviewing airport tenant activities to ensure compliance with agreements; supervising enforcement of aircraft air and ground traffic regulations, participating in airport planning activities; developing the annual budget, including future staffing requirements; coordinating construction and maintenance work with tenants, public utilities and contractors; and representing IFP to the surrounding community. The Airport Director makes recommendations to Authority Officers and Directors on State and Federal regulations and laws impacting IFP operations and development and represents the Airport Authority at meetings and with public officials. The Director administers the capital improvement program including planning, applying for and accepting public grants, and executing contracts for grant-funded projects and authorizing payments.



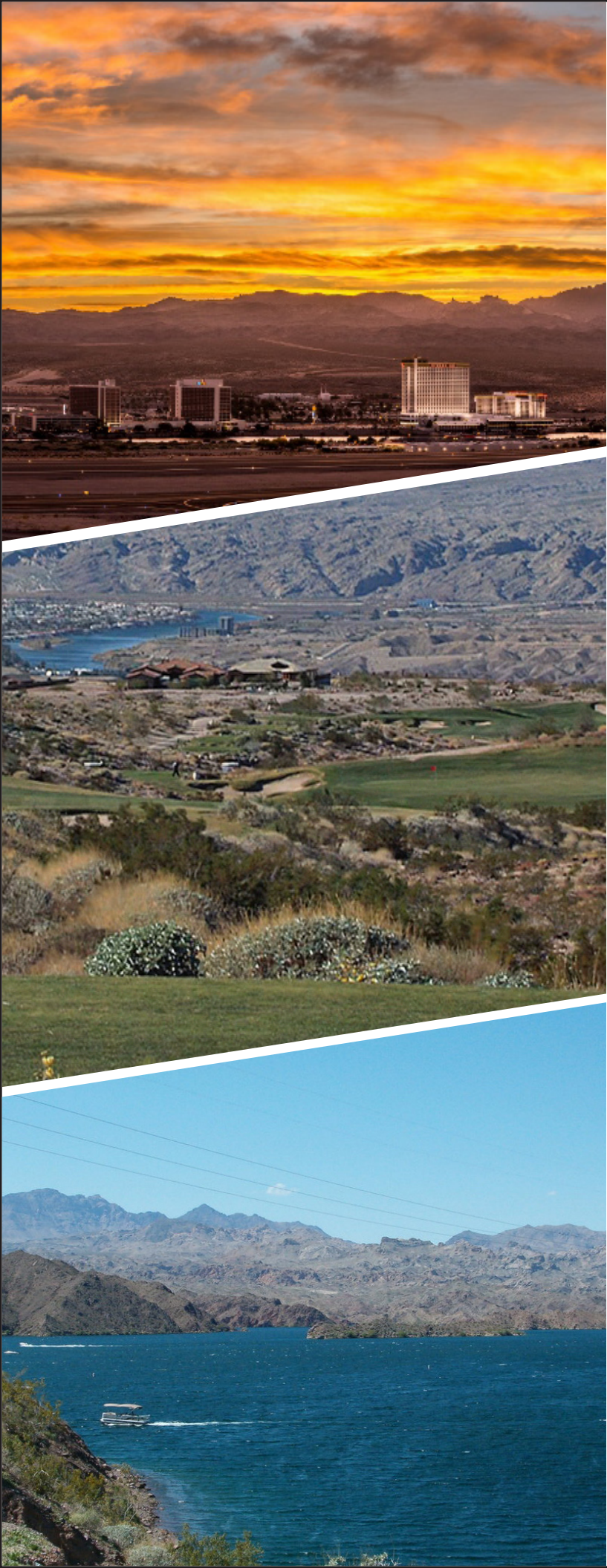

The Position (*continued*)

The Director develops and implements programs to maximize revenue for the operation and maintenance of the Airport as well as capital projects. The Director is the Airport's designated Airport Security Coordinator and develops and administers the Security Program. The Director enforces all laws, ordinances, rules and regulations related to airport operations and associated activities. The Director is also responsible for developing procedures and systems for the maintenance and upkeep of Airport buildings, grounds, structures and equipment. The Airport Director is responsible for administering public relations programs that promote the interests of the Airport and the Airport Authority. The Director prepares reports for the Authority, government agencies and the public, and interfaces with a variety of outside organizations including civic and business organizations as well as governmental agencies.

The Ideal Candidate

The successful candidate for this position will have a 4-year degree in Aviation or Business Management or a related area of study, as well as 3 years' executive level experience at an airport. Five years' experience at the top two levels of airport management may be considered in lieu of a college degree. Candidates with C.M. and A.A.E. accreditation by AAAE are preferred. The successful candidate will have knowledge of applicable Federal, state and local rules and regulations. The candidate will have extensive knowledge of airport maintenance requirements, including supplies, materials and equipment. The candidate will have thorough knowledge of the principles and practices of airport business management, as well as airport real estate management, including leases and contracts. The successful candidate will have the ability to analyze and report on operating conditions and problems, and develop, recommend and implement appropriate solutions. The successful candidate will be able to plan, assign and direct the work of Airport staff and maintain effective working relationships. The candidate must have the ability to present facts clearly and accurately, orally and in writing.



Salary and Compensation

The salary range for this position is \$130,000 to \$150,000. A starting salary at or near the top of the range is possible for the exceptional candidate. IFP offers an attractive benefits package and relocation assistance will be offered.

How To Apply

To apply online, [click here](#).

Deadline for applications: January 29, 2023

The contacts for this search are:

Rod Dinger, A.A.E.,
rod@adkexecutivesearch.com

Dan Sprinkle, A.A.E.,
dan@adkexecutivesearch.com

Please note: After your application is complete, you will receive an important email from us. Please check your inbox and your junk/spam folder, and if you have not received our email, please notify us at:
admin@adkexecutivesearch.com.

The Mohave County Airport Authority is an equal opportunity employer.

