



Spokane International Airport

BUSINESS PARK AND FELTS FIELD

Spokane Airports invites applications for
Senior Project Manager

Spokane International Airport (GEG)
Felts Field (SFF)
Spokane, Washington

EXECUTIVE SEARCH SERVICES PROVIDED BY ADK CONSULTING & EXECUTIVE SEARCH

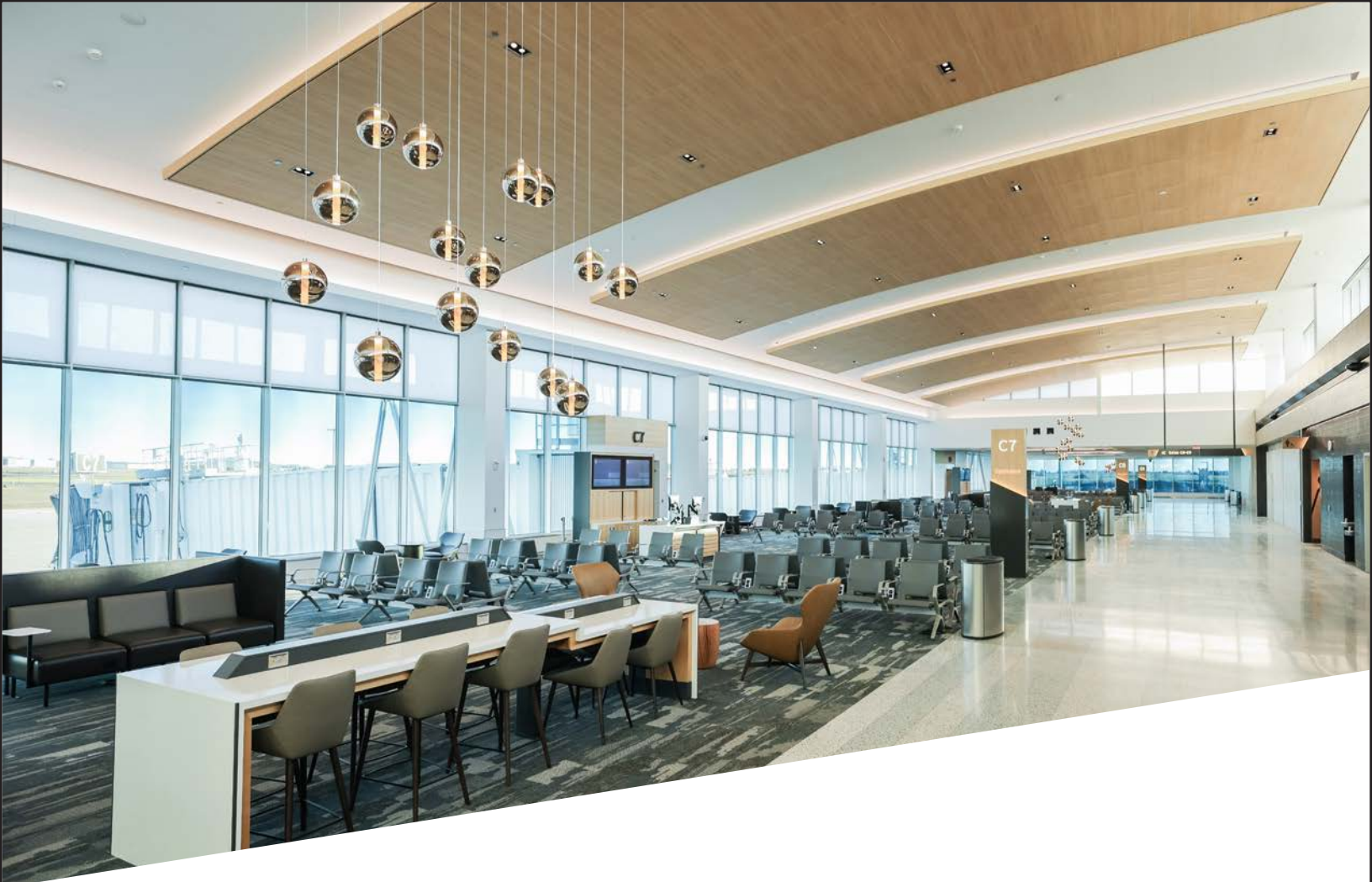

The Airports

Spokane Airports is jointly owned by Spokane County and the City of Spokane and operates under an interlocal agreement. The operating authority of the Airports is the Spokane Airport Board, consisting of seven appointees from the two governmental bodies. The board operates three facilities, and has a Grant of Authority to operate Foreign-Trade Zone No. 224 and also has certain developable portions of its property situated within an Opportunity Zone and a Community Empowerment Zone:

- **Spokane International Airport (GEG):** Situated just five miles west of downtown, GEG is the second largest commercial service airport in the state of Washington, and an important gateway to key markets and destinations across the Inland Northwest and British Columbia. It has two paved runways and is served by seven major airlines (Alaska, Allegiant, American, Delta, Southwest, Sun Country and United), three cargo carriers, and two FBOs, and provides employment for over 3,000 people. The Airport's market area includes parts of Eastern Washington, Northern Idaho, Western Montana and portions of Southern British Columbia and Alberta. In 2024, the Airport proudly welcomed a record total of more than 4.2 million passengers and handled 67,298 tons of cargo. 2025 is forecasted to be another record-breaking year, with 15% more seats scheduled compared to 2024. The Airport also generates approximately \$3 billion in economic impact across the Inland Northwest region – and does so without the use of taxpayer or City or County appropriated funds.
- **Felts Field (SFF)** is a 400-acre general aviation airport and designated reliever facility located approximately five miles east of downtown Spokane. It has two paved runways, a turf landing strip, as well as the ability to accommodate water landings on the adjacent Spokane River. In 2024, the Airport supported 65,109 aircraft operations.
- The **Airport Business Park** is an industrial and business park development that comprises 432 acres. Strategically located adjacent to Spokane International Airport and Interstate 90, it has nine real estate areas designated for future development through third-party development or build-to-suit.

The Airport *(continued)*

- **Rail-Truck Transload Facility:** Spokane is well-connected by air, road and rail, and the Airport's Rail-Truck Transload Center – located approximately two miles west of the passenger terminal on the western edge of Airport property – was strategically created to enhance multi-modal freight services for the area's diverse commercial and industrial sectors and support the regional vision of an advanced aerospace facility. The parcel contains a 2,000ft x 100ft wide concrete maneuvering area, connects to the BNSF main line, and is recognized as a BNSF Certified Site.

Airport Growth

By 2030, more than 6.2 million passengers are expected to pass through Spokane International Airport. The Terminal Renovation and Expansion (TRES) Program is the Airport's multi-year, multi-phase initiative designed to expand and enhance its terminal facility to accommodate this demand. The first phase of the program is the Concourse C Expansion Project: a \$150 million, 144,000-square-foot addition to the Airport's existing terminal building that will be completed in stages through 2026. Importantly, it's also the enabling project that, once completed, positions the Airport to pursue a Central Hall Project to consolidate security screening checkpoints and baggage claim areas, subject to future funding.

Other notable projects that enable the Airport to accommodate the region's increasing growth include: the reconstruction of the primary taxiway from asphalt to concrete; runway pavement improvements; terminal ramp expansion for RON aircraft parking positions; aircraft fuel facility upgrades, including a new fourth tank to accommodate an additional 500,000 gallons of jet-A fuel; enhanced parking and ground transportation facilities; rail-truck transload center additions; an airport master plan update; and other diverse airport multi-modal projects.

About the Spokane Region

Spokane has everything you hope a destination in the Northwest would have. Breathtaking nature, great restaurants and venues, diverse nightlife; all packed into a growing mid-sized city.

The Inland Northwest region extends across over 80,000 square miles and is home to over 1.5 million residents, and Spokane – Washington state's second largest city and seat of Spokane County – is the region's cultural and economic center.

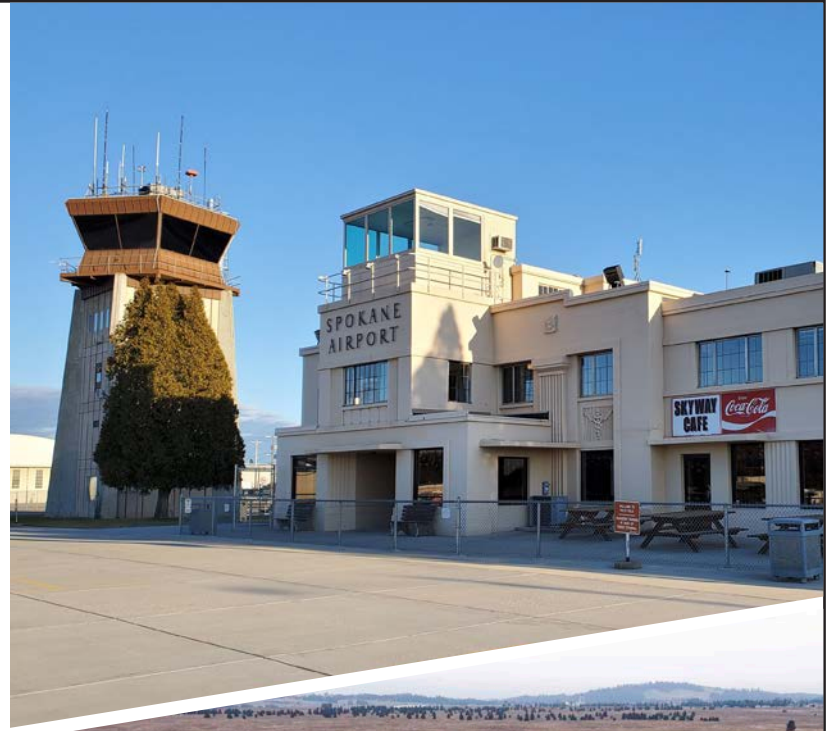

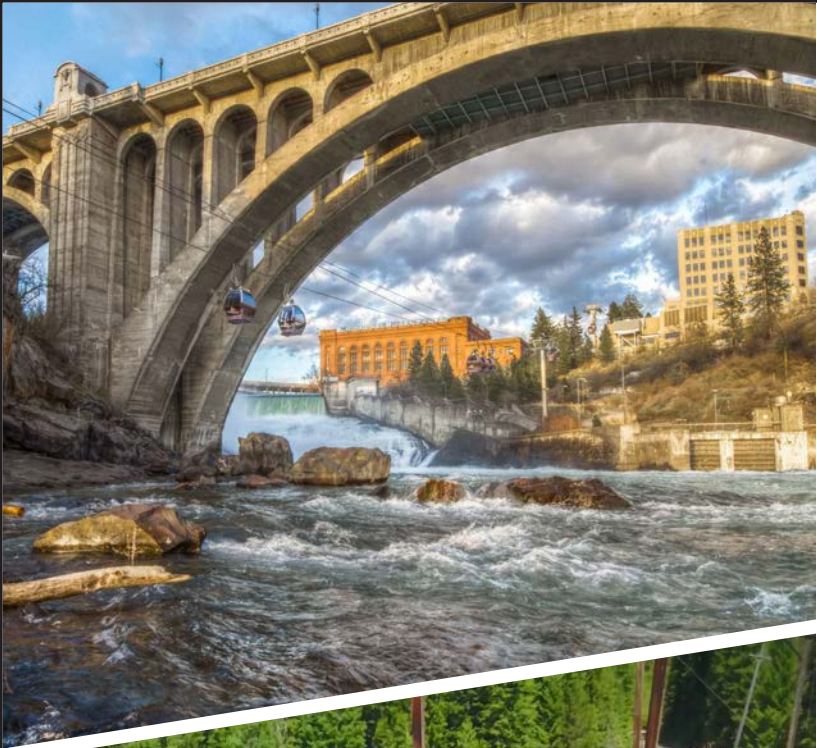

About the Spokane Region (cont.)

The area is located in the eastern portion of the state, approximately 20 miles from the Washington-Idaho border, and has a population of over 670,000. The city's nickname is The Lilac City and its claims to fame include being the birthplace of the Father's Day holiday; the hometown of Bing Crosby; and the host of the 1974 World's Fair. Spokane is the nation's fifth largest aerospace cluster. The city's other anchoring institutions include life sciences, financial services, advanced manufacturing, and Fairchild Air Force Base – home of the world's largest aerial refueling fleet.

Healthcare

Spokane represents the largest healthcare, health services and medical education hub between Seattle to Minneapolis and Calgary and Salt Lake. The city has four full-service hospitals, two of which are the second and third largest in the state.

Outdoor Recreation

Spokane is a beautiful four-season destination, bordered on the west by the Columbia Basin and on the east by the foothills of the Rockies: the Coeur d'Alene mountains. The area is home to four major rivers, 76 lakes and rivers within 50 miles of the city's downtown core, 32 golf courses, nearly 130 parks and five renowned ski and snowboard areas within two hours.

As a cycling-friendly community, Spokane also boasts miles of roadways to ascend and coast, and wooded areas and trails to mountain bike. The most difficult challenge is trying not to stop at every breathtaking vista—save those for when you come back to the trails in your hiking boots.

Spokane Arts & Culture

Spokane's downtown area hugs both sides of the Spokane River and is the vibrant meeting place for artists, performers, curators, musicians, and creatives of all types. Alongside our renowned wineries and urban river gorge, you will find a treasure trove of art galleries, museums, theaters, and historic buildings.

Take in a Broadway show, enjoy a night at the symphony, or have some laughs at one of the area's comedy clubs. Explore world-class museums. And satisfy your shopping sensation in sparkling new malls, unique boutiques, world-renowned department stores, and eclectic antique galleries.

Spokane has a long history of dedication to the arts. You can see that in our art galleries, many of which focus on promoting the work of local and regional artists. Whether you find yourself drawn to the Corbin Art Center, the New Moon Art Gallery, or the Chase Gallery in our own city hall, the artwork nurtured by our community tastemakers is not to be missed.

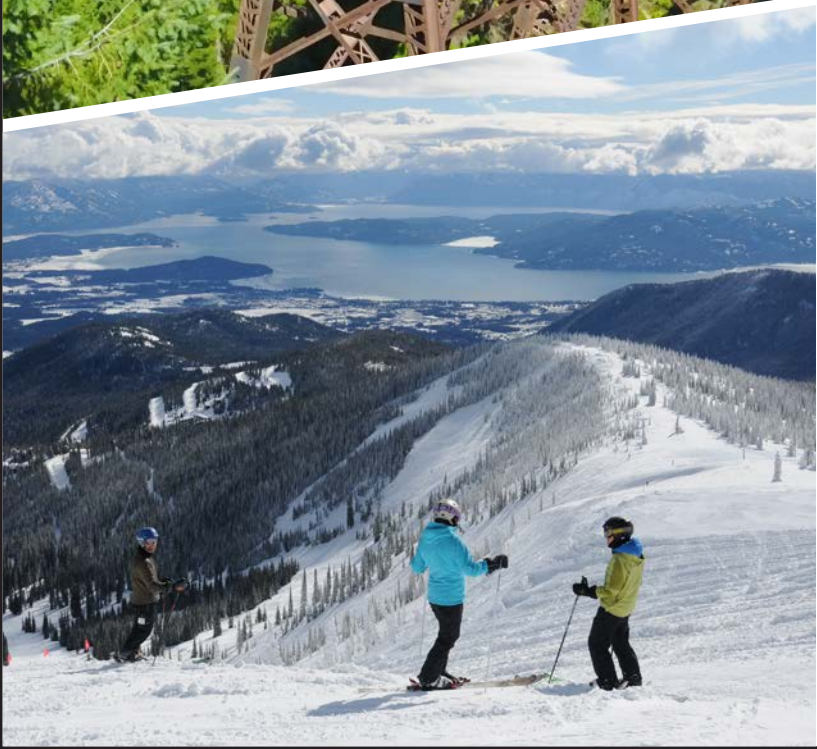

About the Spokane Region (cont.)

Education

Spokane is a major hub for education in the Inland Northwest region with more than 75,000 students and nearly a dozen colleges and universities located within 90 miles. There are excellent public and private school options for elementary, junior high, and high school students. Higher education establishments include Eastern Washington University, Washington State University at the Riverpoint Campus, the Community Colleges of Spokane, Gonzaga University, and Whitworth University. Spokane boasts two medical schools, three nursing schools, and Washington State University's undergraduate, graduate, and doctoral Pharmacy school.

Sports

Spokane is a sports mecca. College basketball lovers will find their fix with the Gonzaga University men's and women's basketball teams. In March, the Spokane Arena annually hosts the 1st and 2nd rounds of the NCAA tournament. If it's football you're looking for, three local universities, Eastern Washington University, Washington State University and Whitworth University, deliver. In the winter, Spokane Chiefs hockey scores, and summer brings the sound of cheers at Spokane Indians baseball games. The Podium, a new state-of-the-art indoor hydraulic-banked track and field venue, draws numerous amateur and professional competitive events, and ONE Spokane Stadium – the city's newest sporting and entertainment venue – is host to Spokane's two United Soccer League (USL) teams. Sports enthusiasts also enjoy Hoopfest, the world's largest, annual 3-on-3 basketball tournament; Bloomsday, one of the nation's largest timed 10K runs that attracts 50,000 runners to Spokane's downtown streets; and the Coeur d'Alene Ironman, hosted every June along pristine Lake Coeur d'Alene. In addition, the Spokane Arena is the perennial host to the State 'B' Basketball Tournament, which brings athletes and fans from across Washington to Spokane.

Culinary

This foodie paradise will tempt you with every type of cuisine and all the latest food trends. The many local chefs dedicated to culinary craft and excellence are helping to make a name for Spokane on the national food scene. You'll find the perfect restaurant to suit any occasion or appetite. Looking to nibble and chat? Check out any of the cafés and coffee shops serving up pastries and sandwiches. Want a meal paired with the perfect local wine or brew? There are plenty of wineries and breweries to choose from. If you're feeling a little adventurous, explore the local Northwestern fare and see what the chefs are cooking up with ingredients sourced from nearby farms or even their own gardens. And if you're interested in sampling far-flung flavors, Spokane has that covered as well. Global tastes have their place in this mini metropolis where diverse cultures converge. In Spokane, there's a plate for every palate.



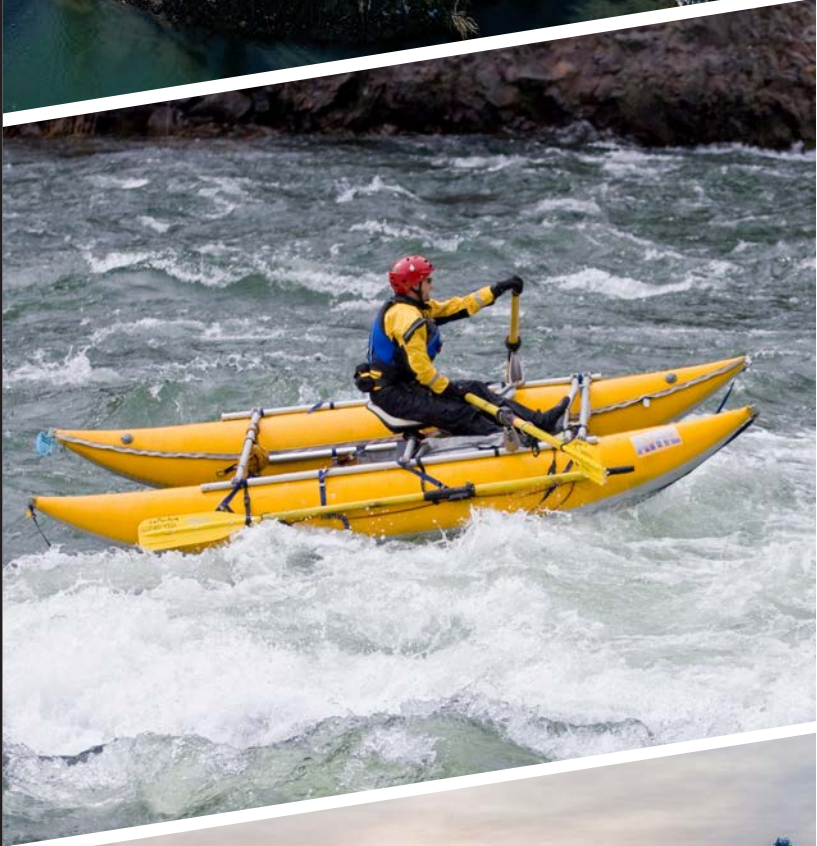

Position Overview

The Senior Project Manager plays a crucial role in managing complex airside and landside facility improvement projects at the Airport. This position ensures successful project execution from conception to completion, collaborating with internal departments and external stakeholders to enhance airport infrastructure. The role also involves working strategically with airport leadership to identify and prioritize future capital improvement initiatives.

About the Role

The Senior Project Manager oversees the planning, environmental considerations, design, and construction of airport modernization, rehabilitation, and new construction projects. This senior-level position administers contracts, manages consultant and contractor teams, and ensures compliance with federal, state, and local regulations.

Key Responsibilities

- Assist in developing and prioritizing capital improvement projects, aligning with airport leadership goals.
- Define project scope, budgets, and timelines for multi-disciplined vertical and horizontal infrastructure projects.
- Manage consultant and contractor teams, overseeing public works projects.
- Coordinate with internal departments and external agencies to facilitate project execution.
- Administer and monitor contracts, ensuring compliance with project specifications and regulatory requirements.
- Communicate project objectives, progress, and challenges to stakeholders, public agencies, and technical committees.



Leadership Qualities and Style

- Strategic thinker with the ability to align infrastructure improvements with airport objectives.
- Strong communicator who can effectively present complex project details to diverse audiences.
- Collaborative leader who fosters productive relationships with co-workers, consultants, and contractors.
- Detail-oriented professional capable of managing multiple projects within tight deadlines.
- Ethical and accountable, upholding high standards in public administration and airport operations.

Preferred Qualifications

- Bachelor's degree in planning, architecture, engineering, construction management, or a related field.
- Minimum of twelve (12) years of experience in design and construction project management with budgeting.
- An equivalent combination of education and experience may be considered.
- Experience managing Federal Aviation Administration (FAA) projects at a commercial service airport desired.
- Strong knowledge of capital program procedures, airport facility design, and construction methodologies.
- Proven ability to oversee project budgets, schedules, and regulatory compliance.

For a full job description, [click here](#).

Salary and Compensation

The salary range is \$101,260 - \$143,490. The starting salary will be dependant upon qualifications. Current benefits include medical, dental, life and disability insurance, retirement as well as employee assistance and wellness programs. Holiday, sick and vacation time are also provided. Relocation assistance is available.





How To Apply

To apply online, [click here](#).

Deadline for applications: May 11, 2025

The contact for this search is:

Rod Dinger, A.A.E.
rod@adkexecutivesearch.com

Dan Sprinkle, A.A.E.
dan@adkexecutivesearch.com

Please note: After your application is complete, you will receive an important email from us. Please check your inbox and your junk/spam folder, and if you have not received our email, please notify us at: admin@adkexecutivesearch.com.

Spokane Airports are an equal-opportunity employer. We support diversity and are committed to creating an inclusive environment for employees.

